



## Lever hoist | MRO | 9.000 kg

- The lever hoist in the MRO and MRT series have a steel construction. The steel construction is an impact resistant cover that provides durability and protection.
- The lever hoist has a short ratchet lever so that the required force remains minimal.
- Compact design, smaller body and lightweight for low headroom applications and use in confined spaces.
- An automatic load pressure brake that guarantees a secure hold of the load in any position.
- The hoists have a powder coating which provides a long-lasting finish in hostile environments.
- Caged needle bearing design increases efficiency and creates a smooth operation.
- Forged alloy steel hooks cast steel safety latches.

### Difference between MRO and MRT

The MRO series lever hoists have overload protection. As a result, you immediately save on repair costs, the hoist has a longer lifespan, and you work safer.



Type	MRO
Brand	Mitari
Finish	Powder coating
Lifting direction	360°
Hooks	Swivel top and bottom hooks
Chain falls	3
Chain length	Available from 1.5 meters
Chain	Electro-galvanized T-hardened
Temperature range	-10 °C to + 40 °C
Norm hoist	NEN-EN 12100-1/2
Norm chain	DIN-EN 10204 EN 818-7
HS code	8425190000

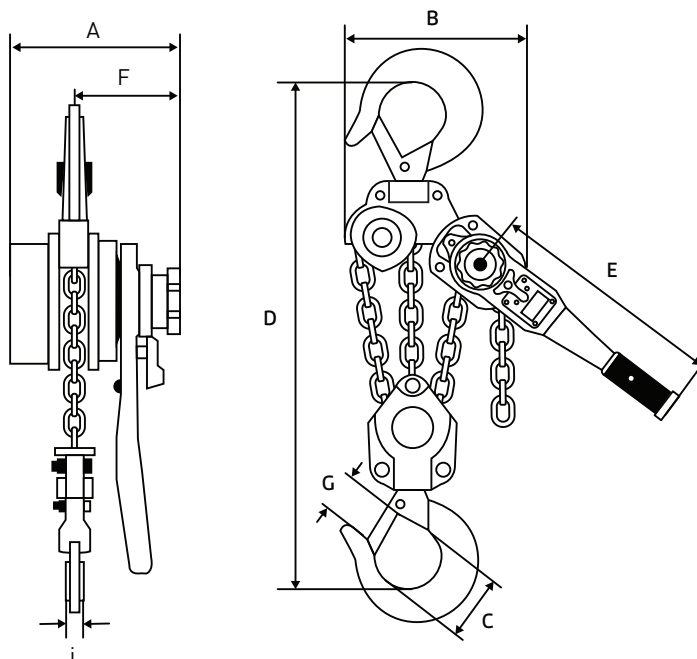

WLL kg	Chain size mm	A mm	B mm	C mm	D mm	E mm	F mm	G mm	H mm	I mm	Weight kg
9.000	10 x 30	196	298	85	680	415	114	64	85	40	42